

ETE PNW Modular Update

Oct 5, 2023



2023-24 Show Schedule

- [Current schedule is here](#) - see which ones you can join
- Potential future shows:
 - Washington State History Museum Christmas Show
 - Setup Dec 17-21
 - Show: Dec 22-Jan 1; closed Dec 24-25; total 9 days
 - [EuroWest 2024](#), July?, Hiller Aviation Museum in San Carlos, CA
 - Leavenworth, WA. Fall 2024
 - Kelso spring show; May4-5
 - Others?

Washington State Museum Train Festival

- Setup Dec 17-21
- Show: Dec 22-Jan 1; closed Dec 24-25; total 9 days

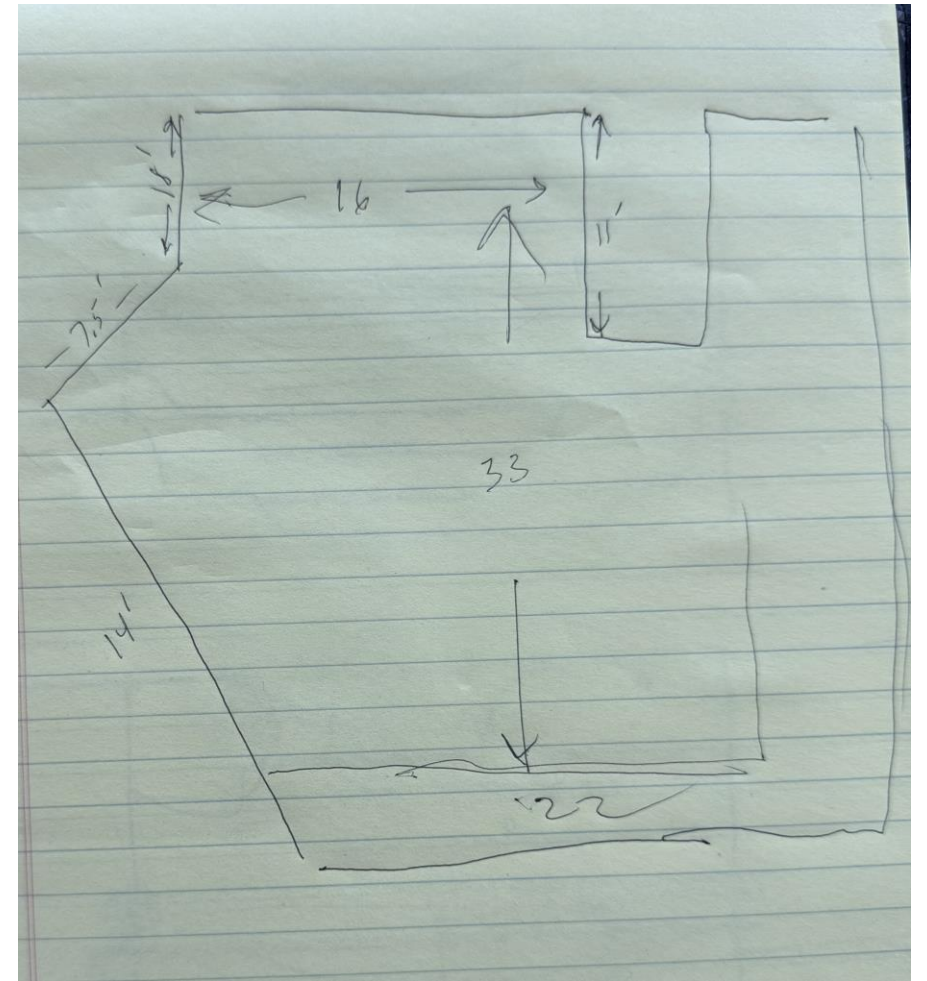
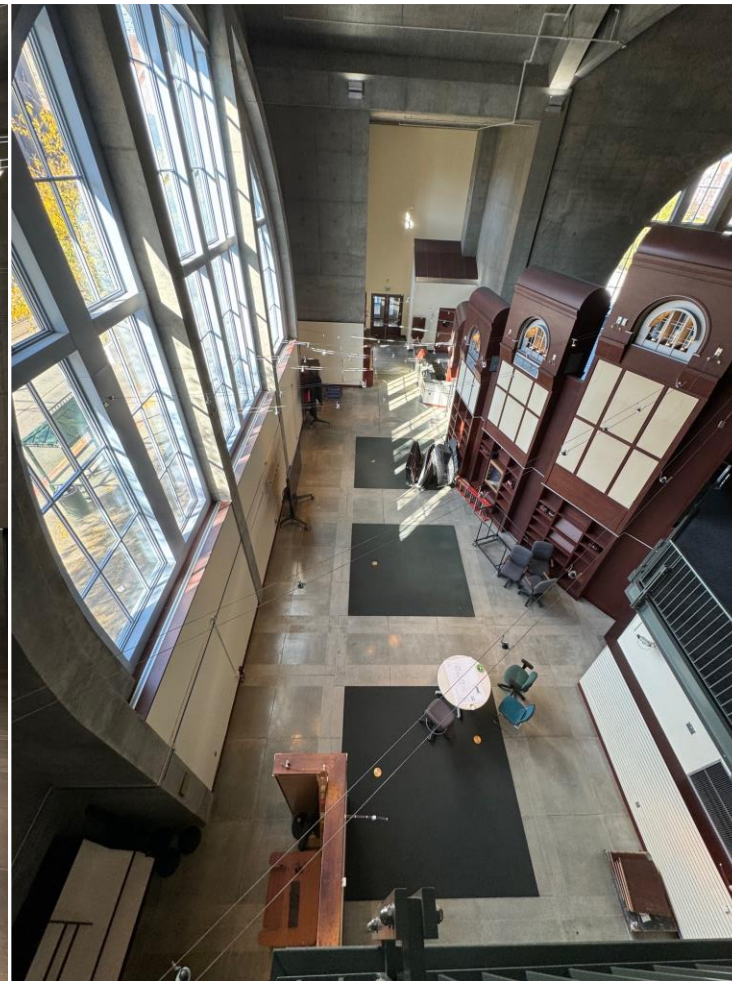
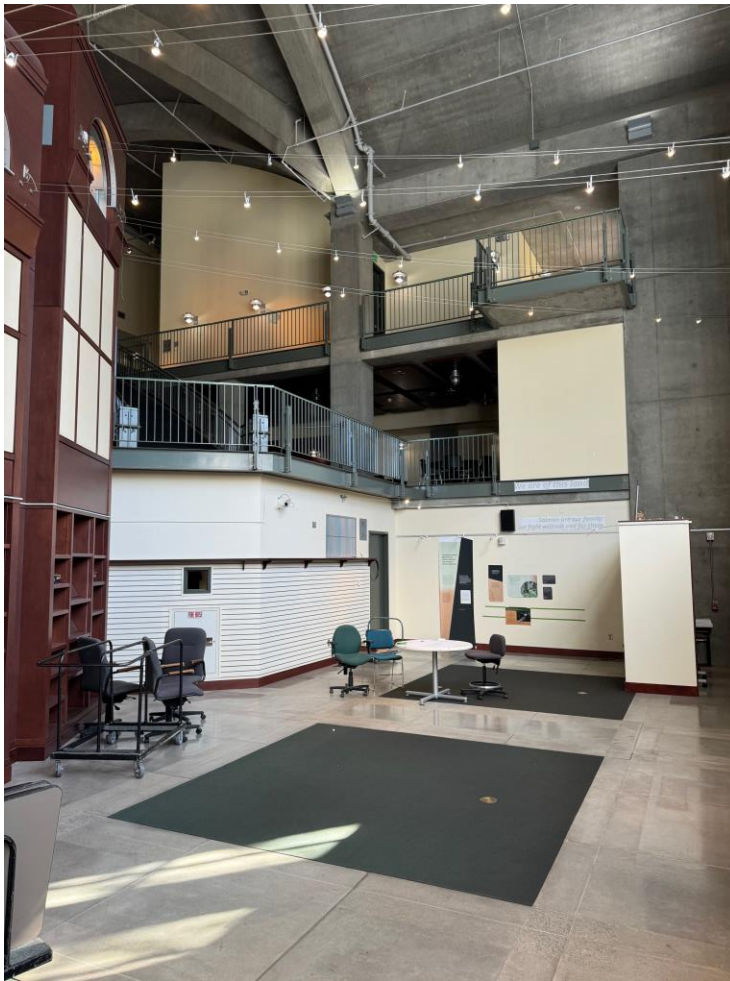

Inventory and Status of Modules

#	Module	Owner	Type	Material	Size	Status
1	Large Loop	Howard	End Module	Wood	7' x 5'	Operational
2	Small Loop	Howard	End Module	Wood	6' x 4'	Operational
3	Mid	Chris	Straight Rural	Wood	5' x 3'	Operational
4	Mid	Chris	Straight Rural(?)	Alum	5' x 3'	Development
5	Mid	Thom	Straight Rural(?)	Wood	5' x 3'	Development
6	Mid	Thom	Straight Rural	Alum	5' x 3'	Not started
7	Mid	Jan/Hans	Straight Military?	Wood	5' x 3'	Development
8	Corner	Doug	Corner	Alum	?	Not Started
9	Station	Paolo/Stein	Station	Alum	80" x 41"	Development
10	Mid + DC staging	Magnus	Straight City/staging	Alum	5' x 3'	Development
11	Mid + DC staging	Magnus	Straight City/staging	Alum	5' x 3'	Not started
12	Mid	Eugenio	Straight	Alum	5' x 3'	Not started

Actions: Pls confirm the info here if you are building a module; if you want to build a module pls reach out to Magnus

ETE PNW

Current Layout



Christmas Show?

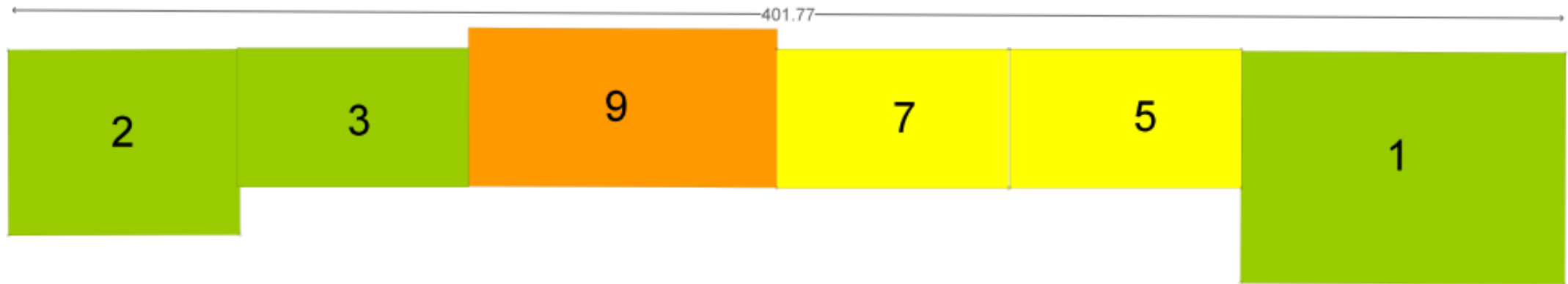

$$6+5+7+5+5+7=35'$$

Action: If you want, to order badge and “uniform” for our shows, go to ete.org and log in to member section

Badges and Clothes



European Train Enthusiasts

The Premier North American Organization

Focused on European Railroading...

Home

Membership

Chapters

EuroShows

EXPRESS

Modules

Layouts

Members

About Us

Welcome to the ETE Members Area

This area contains exclusive content for ETE members only.

ETE EXPRESS

Members may access all Past and Current Issues of the EXPRESS

- Most Recent EXPRESS Issue
- ISSUE Index
- ARTICLE Index

ETE EXPRESS ONLINE

Members may access and replay all past Zoom Meetings of ETE EXPRESS ONLINE

- MEETING Index
- PRESENTATION Index

Membership Directory

- Directory of ETE Members

Member Resources

- [Form to Order Name Badges](#)
- [Order ETE Shirts from Land's End](#)
- [Order SPECIAL ETE 50th Anniversary Kaki Shirts](#)
- [Logos of European Railways Book](#)

Chapter Leader Resources

- [Annual Chapter Renewal Form](#)
- [Logos and Branding Information and Artwork](#)

Your National Board of Directors

- [ETE Board Contact Infomation and Meeting Minutes](#)

Hi Magnus Christerson,

Log out

NOTE: Once you leave the Members Area to go to other areas on the Website, you will need to Log Out and Log In again.



EUROPEAN TRAIN ENTHUSIASTS

Name Badge Order Form

You may order an ETE name badge as pictured below. Badges have a cream background with burgundy lettering and come with a magnetic clasp. Please be sure to specify your local chapter affiliation.

Your order will generally be shipped to you within 48 hours of receipt. Your check for \$8.00 (tax included) plus \$1.00 shipping and handling per badge must accompany your order. TOTAL \$9.00 per badge. Please mail orders, and make checks payable to:

ClassAct Signs & Wraps 23142 Alcalde Drive, Suite D2, Laguna Hills, CA 92653
Phone 949-855-6578 email: sales@classactsigns.com



European Train Enthusiasts
JOE EUROFAN
Local Chapter Name

SHIP TO: Name: _____

Address: _____

City: _____ State: _____ Zip: _____

Phone: _____ email: _____

Name as you would like it to appear on badge: _____



European Train Enthusiasts

Search

Hi, Sign in MY ACCOUNT

MEN

WOMEN

TRA

Home > Men

CATEGORIES

7 Products

Sort by: Recommended

36 per page

Men

Shop All Men (7)

Outerwear (3)

Shirts (4)

GENDER CATEGORY

MINIMUM QUANTITY

FEATURED BRANDS

SIZE RANGE

☐ Regular (7)

☐ Tall (3)

☐ Big (6)

FIT

SLEEVE LENGTH

PATTERN

FABRIC NAME

FABRIC CONTENT





Men's Embroidered Logo Short Sleeve Polyester Polo Shirt
\$27.95



Men's Thermacheck 100 Custom Embroidered Fleece Jacket
\$48.95



Men's Custom Logo Banded Short Sleeve Cotton Mesh Polo Shirt
\$34.95



Module Builder Workshop - Nov 18

- November 18 @ 10am in Gig Harbor;
- Stein and Magnus will send out details;
- send proposed topics to Alan you want to work on;
- we will try to set up our layout and test it for the Jan-Feb shows;
- bring your module if you are working on one.



Trailer

Kid Module – Test in Chehalis

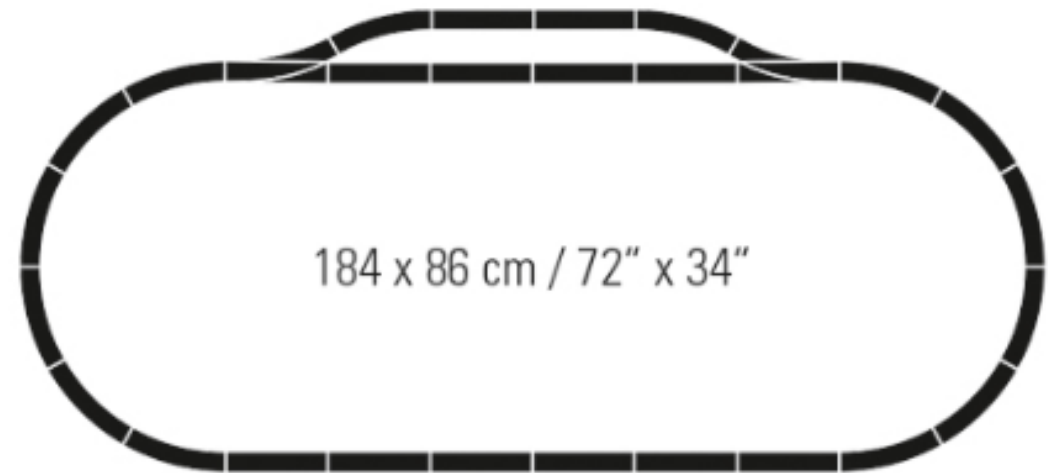

Other topics

1. Kids layout
 - Action: Set up test layout in Chehalis; Peter has Marklin kids kit; anyone volunteer to manage this?
2. For Sale table at shows / fundraising
 - We will have 2 tables in Chehalis to sell donated items for fundraising; Chris will send out more info on this; anyone volunteer to manage this?
3. Module Builder Workshop
 - November 18 @ 10am in Gig Harbor; Stein and Magnus will send out details; send proposed topics to Alan you want to work on; we will try to set up our layout and test it for the Jan-Feb shows; bring your module if you are working on one.
4. Name change for group:
 - FreeMoSIG → Modular@Etepacnw.groups.io
 - Action: Magnus will change this; will send out notification 48hrs before if you need to change email filters etc.